

# QUIETAIRE HEAVY DUTY SILENCERS MA and MB Series

1/8" to 2" BSPT, BSPP



Reduce the noise levels of pneumatic equipment  
 High flow capacity with low back pressure  
 Brass mesh screen and aluminium construction provide improved flow, longer life and cleanable element

## TECHNICAL DATA

**Medium:**  
 Compressed air, filtered, lubricated and non-lubricated, inert gases

**Operating pressure:**  
 20 bar max.

**Ambient temperature:**  
 -20°C to +80°C  
 Consult our Technical Service for use below +2°C

**Operation:**  
 Exhaust silencer

## MATERIALS

Body: aluminium and shell  
 Filter element: brass mesh

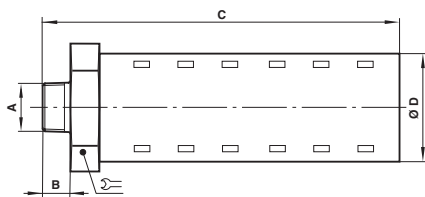

A	B	C	ØD	:	MODELS
1/8 inch	9	51	21	21	MB001B, ...A
1/4 inch	13	55	21	21	MB002B, ...A
3/8 inch	13	55	21	21	MBP03B, ...A
3/8 inch	13	88	32	32	MB003B, ...A
1/2 inch	17	92	32	32	MB004B, ...A
3/4 inch	17	92	32	32	MBP06B, ...A
3/4 inch	20	134	51	51	MB006B, ...A
1 inch	23	138	51	51	MB008B, ...A
1 1/4 inch	26	140	51	51	MBP10B, ...A

### Male

Port size	Flow factor			kg	MODELS	
	Cv	C *1)	Kv *2)		BSPT	NPT
1/8	2	8,2	1,75	0,03	MB001B	MB001A
1/4	2,2	9	1,92	0,03	MB002B	MB002A
3/8	2,94	12	2,56	0,03	MBP03B	MBP03A
3/8	4,78	19,5	4,16	0,10	MB003B	MB003A
1/2	5,49	22,4	4,78	0,09	MB004B	MB004A
3/4	5,49	22,4	4,78	0,09	MBP06B	MBP06A
3/4	12,5	51	10,78	0,45	MB006B	MB006A
1	15,68	64	13,65	0,40	MB008B	MB008A
1 1/4	16,67	68	14,5	0,40	MBP10B	MBP10A



\*1) Measured in dm<sup>3</sup>/(s.bar)

\*2) Measured in m<sup>3</sup>/h

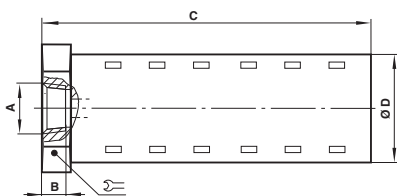

A	B	C	ØD	:	MODELS
1/8 inch	6	42	21	21	MA001A, ...B
1/4 inch	9	45	21	21	MA002A, ...B
3/8 inch	9	78	32	32	MA003A, ...B
1/2 inch	12	83	32	32	MA004A, ...B
3/4 inch	12	118	51	51	MA006A, ...B
1 inch	15	118	51	51	MA008A, ...B
1 1/4 inch	15	144	64	64	MA010A, ...C
1 1/2 inch	15	144	64	64	MA012A, ...C
2 inch	16	168	76	76	MA016A, ...C

### Female

Port size	Flow factor			kg	MODELS		
	Cv	C *1)	Kv *2)		BSPT	BSPP	NPT
1/8	2	8,2	1,75	0,03	MA001B	-	MA001 A
1/4	2,57	10,5	1,29	0,03	MA002B	-	MA002 A
3/8	5,83	23,8	5,07	0,10	MA003B	-	MA003 A
1/2	5,71	23,3	4,97	0,09	MA004B	-	MA004 A
3/4	16,18	66	14,07	0,45	MA006B	-	MA006 A
1	16,67	68	14,5	0,40	MA008B	-	MA008 A
1 1/4	26,7	110	23,45	0,62	-	MA0010C	MA010 A
1 1/2	40,93	167	35,6	0,60	-	MA0012C	MA012 A
2	53,9	220	46,9	0,76	-	MA0016C	MA016 A



\*1) Measured in dm<sup>3</sup>/(s.bar)

\*2) Measured in m<sup>3</sup>/h

For further information



www.norgren.com/info/en7-109

## ADDITIONAL SILENCERS

### SINTERED BRONZE SILENCERS, T40 SERIES

BSPT	MODELS	BSPP	MODELS
		M5	T40M0500
1/8	T40B1800	1/8	T40C1800
1/4	T40B2800	1/4	T40C2800
3/8	T40B3800	3/8	T40C3800
1/2	T40B4800	1/2	T40C4800
3/4	T40B6800	3/4	T40C6800
1	T40B8800	1	T40C8800

Reduce the noise levels of pneumatic equipment.  
 Compact and efficient.  
 Screw directly into the exhaust port.  
 Prevent the ingress of dirt.



### M/S & T45 POROUS PLASTIC SILENCERS

BSPT	MODELS
M5	M/S0
1/8	M/S1
1/4	M/S2
3/8	M/S3
1/2	M/S4
3/4	M/S6
1	M/S8

Reduce the noise levels of pneumatic equipment  
 Compact, efficient and lightweight  
 Screw directly into the exhaust port  
 Prevent the ingress of dirt



Threaded silencers

O/D Tube	MODELS
4	T45P0004
6	T45P0006
8	T45P0008
10	T45P0010
12	T45P0012

Reduce the noise levels of pneumatic equipment  
 Compact, efficient and lightweight  
 Insert directly into Push-In Fitting exhaust port  
 Prevent the ingress of dirt



Stem or PIF silencers

### EXHAUST FILTERS

BSPP	MODELS
G1/8	M/1511
G1/4	M/1512
G1/2	M/1514
G3/4	M/1516
G1	M/1518

Prevent the ingress of dirt with minimal flow restriction  
 Robust and compact  
 Screw directly into the exhaust port



For further information



[www.norgren.com/info/en7-110](http://www.norgren.com/info/en7-110)